



US00D672690S

(12) **United States Design Patent**  
**Augustin**

(10) **Patent No.:** **US D672,690 S**

(45) **Date of Patent:** **\*\* Dec. 18, 2012**

(54) **BICYCLE FRAME**

(75) Inventor: **Stephan Augustin**, Munich (DE)

(73) Assignee: **Bayerische Motoren Werke Aktiengesellschaft**, Munich (DE)

(\*\*) Term: **14 Years**

(21) Appl. No.: **29/408,645**

(22) Filed: **Dec. 15, 2011**

(30) **Foreign Application Priority Data**

Jun. 16, 2011 (DE) ..... 402011003169

(51) **LOC (9) Cl.** ..... **12-11**

(52) **U.S. Cl.** ..... **D12/111**

(58) **Field of Classification Search** ..... D12/111,  
D12/117, 110; 180/65.1, 65.6-65.8, 68.5,  
180/65.31, 205.1-205.7, 206.1-206.8, 207.1-207.3,  
180/219, 220, 221-223, 311, 312, 228;  
280/274-280, 281.1, 283-288, 288.1-288.4,  
280/210, 212, 214, 215, 230

See application file for complete search history.

(56) **References Cited**

**U.S. PATENT DOCUMENTS**

6,119,801 A \* 9/2000 Yamashita et al. .... 180/205.5  
6,286,642 B1 \* 9/2001 Yi ..... 188/319.2  
6,629,574 B2 \* 10/2003 Turner ..... 180/220  
6,719,081 B2 \* 4/2004 Liao et al. .... 180/220

D620,400 S \* 7/2010 Haller et al. .... D12/111  
D620,401 S \* 7/2010 Haller et al. .... D12/111  
7,963,357 B2 \* 6/2011 Gulas ..... 180/206.5  
D650,724 S \* 12/2011 Chiang ..... D12/111

\* cited by examiner

*Primary Examiner* — Susan M Lee

*Assistant Examiner* — Linda G. Brooks

(74) *Attorney, Agent, or Firm* — Crowell & Moring LLP

(57) **CLAIM**

The ornamental design for a bicycle frame, as shown and described.

**DESCRIPTION**

FIG. 1 is a front perspective view of a bicycle frame according to my design;

FIG. 2 is a rear perspective view thereof;

FIG. 3 is a left side view thereof;

FIG. 4 is a right side view thereof;

FIG. 5 is a front view thereof;

FIG. 6 is a rear view thereof;

FIG. 7 is a top view thereof; and,

FIG. 8 is a bottom view thereof.

The broken lines inside the frame tubes illustrate the boundaries of the claimed design, while the other broken lines illustrate environmental structure. None of the broken lines form part of the claimed design.

**1 Claim, 6 Drawing Sheets**

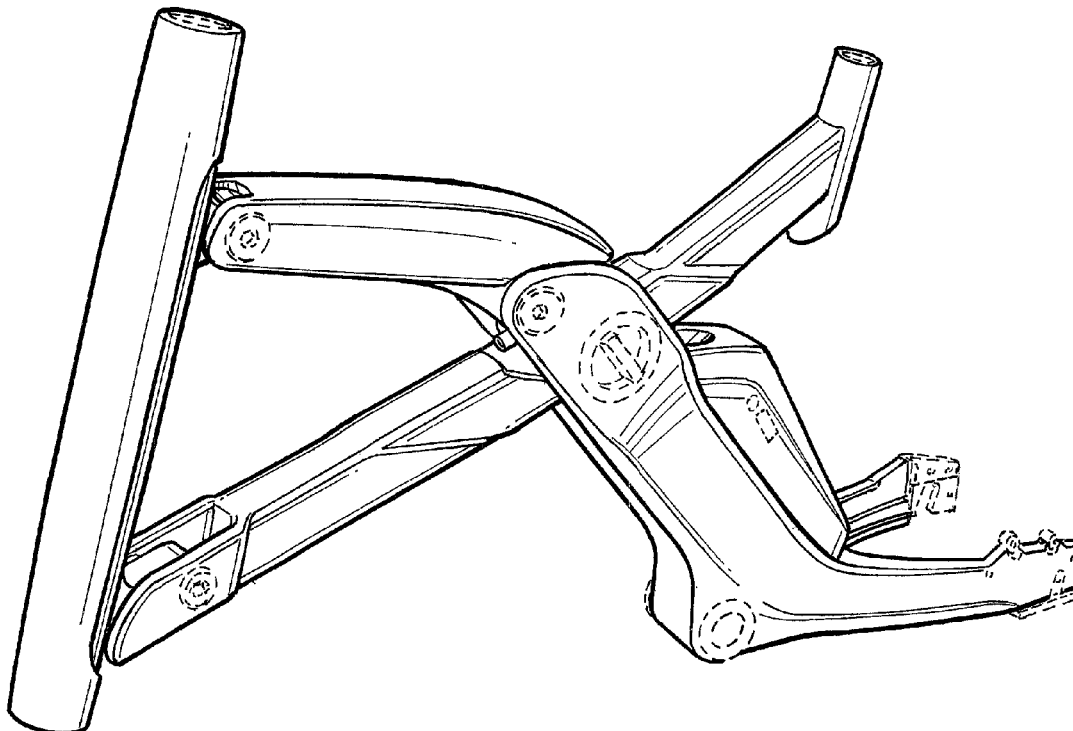

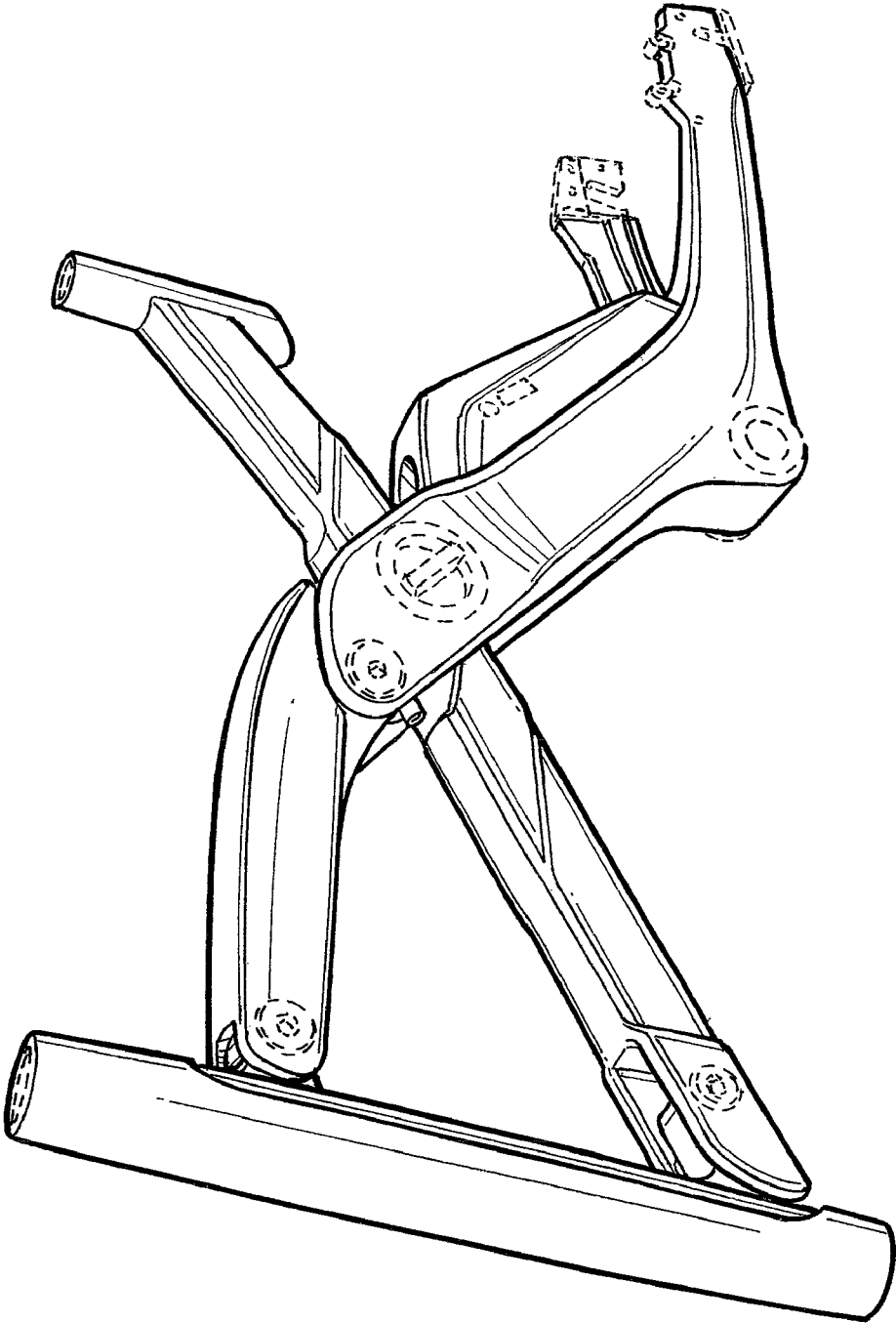

FIG. 1

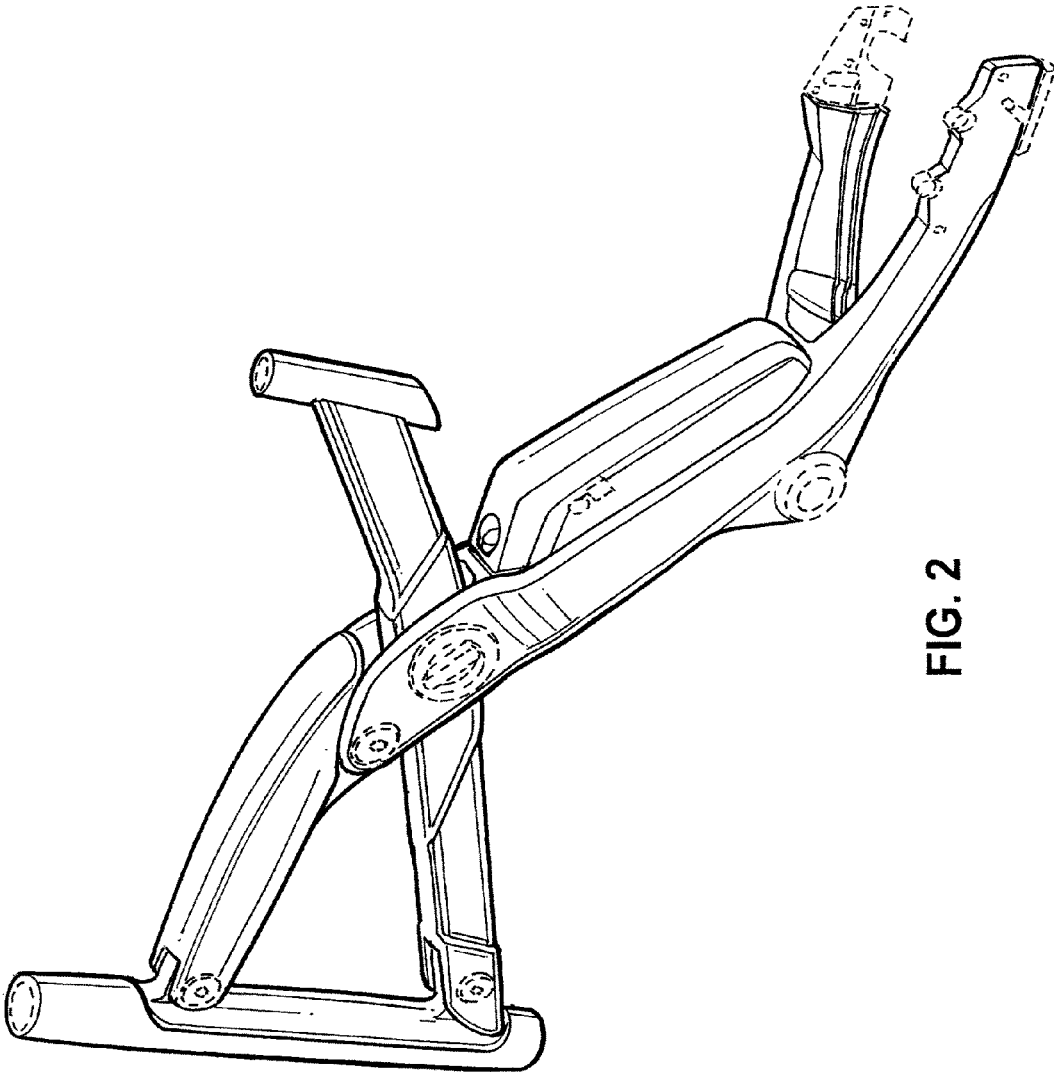

FIG. 2

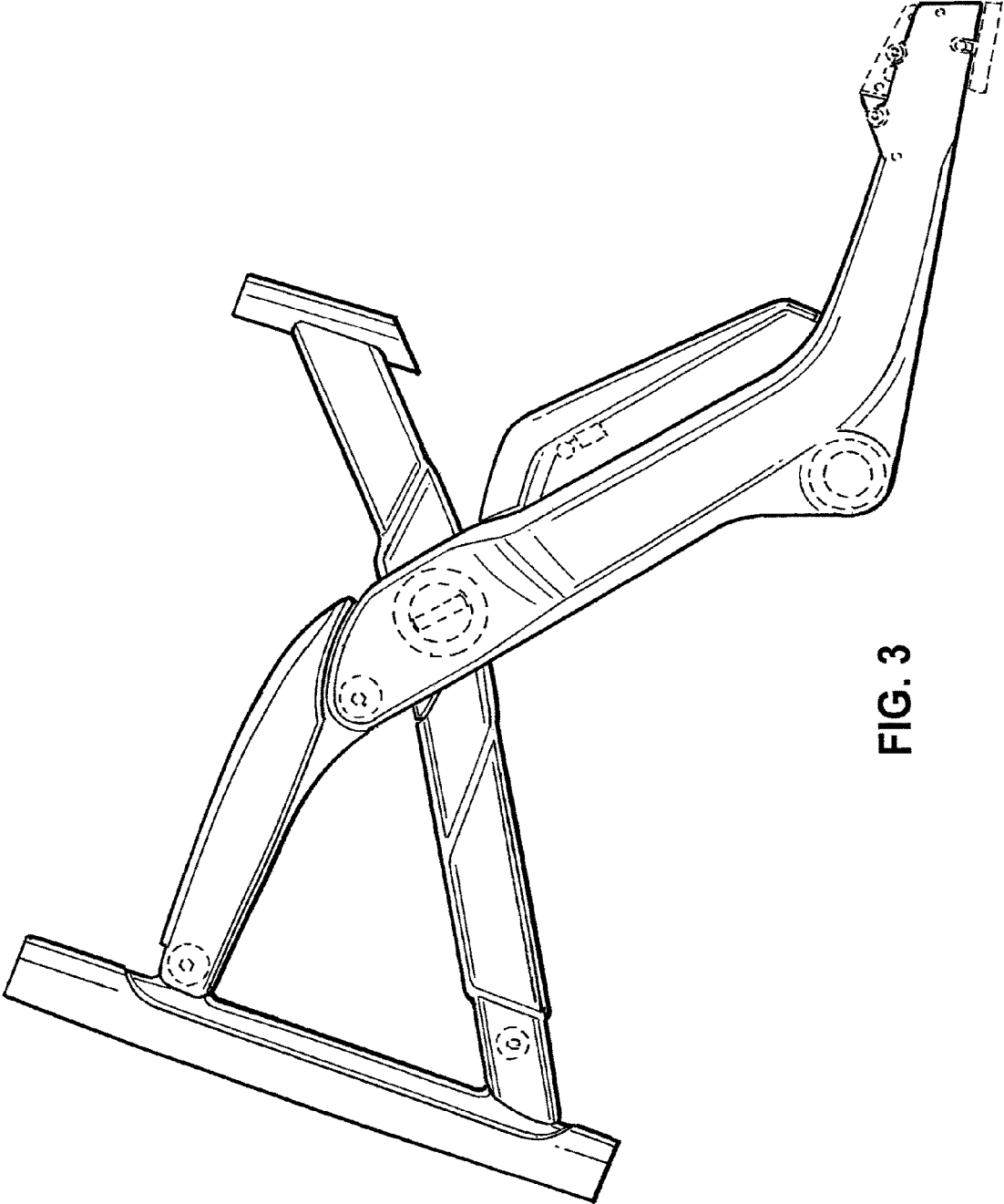

FIG. 3

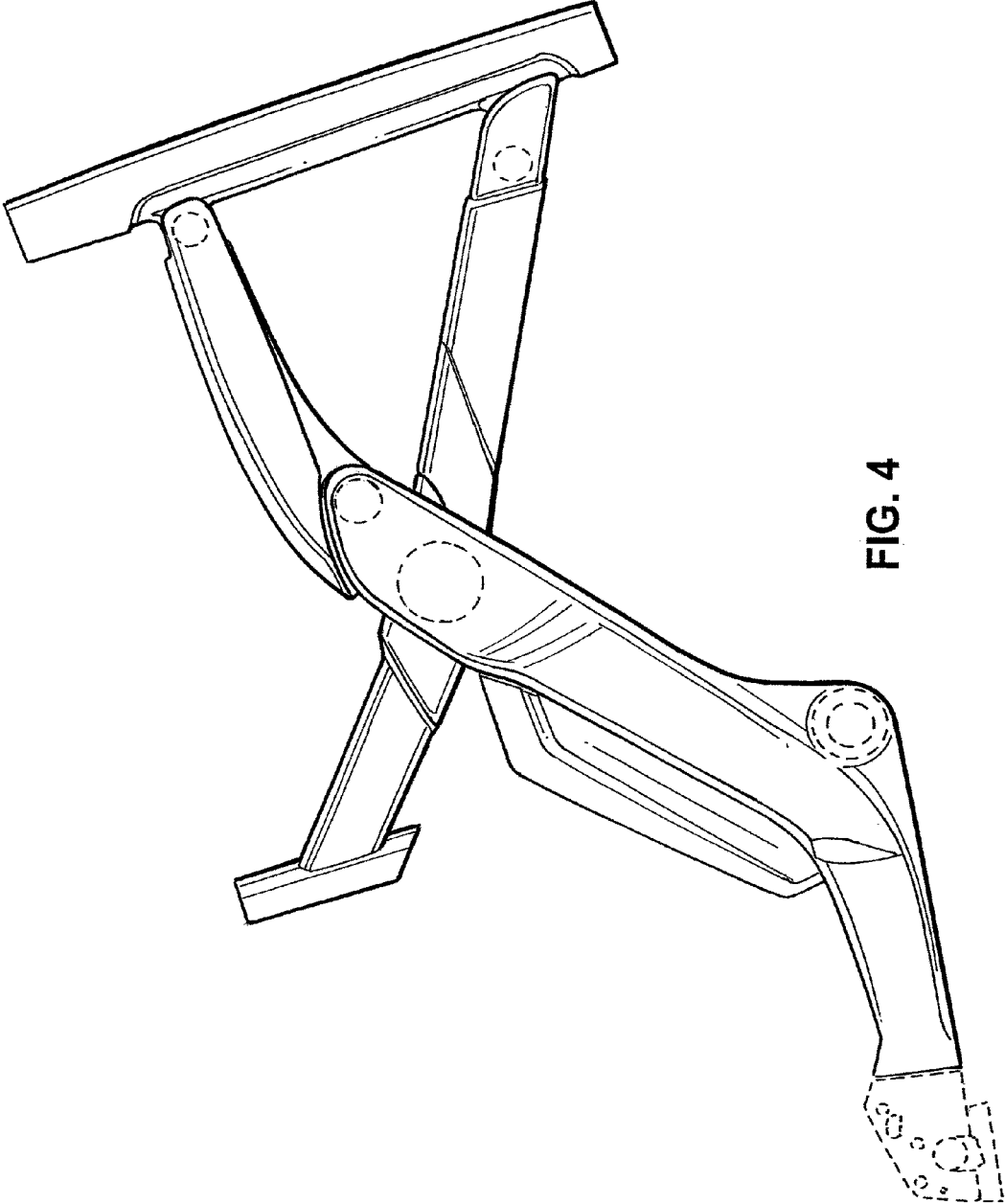

FIG. 4

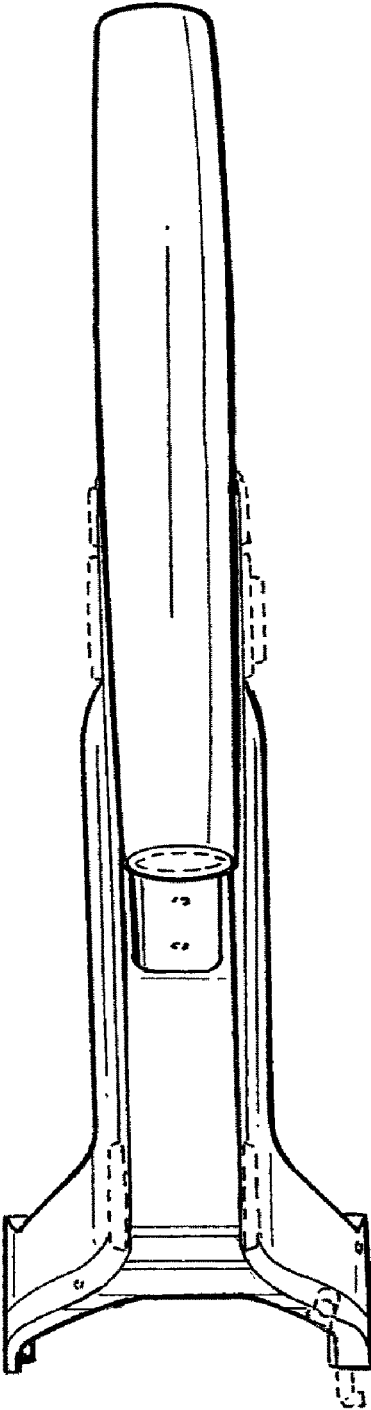

FIG. 5

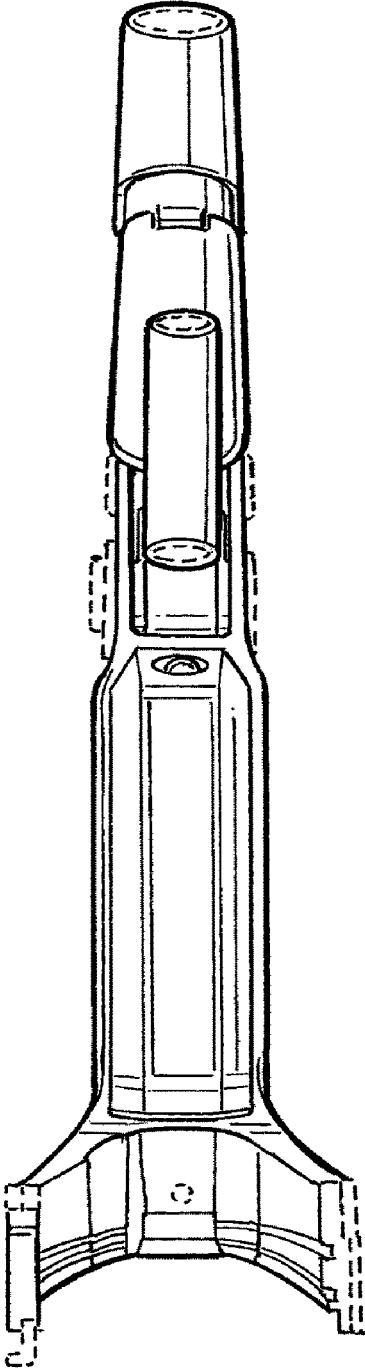

FIG. 6

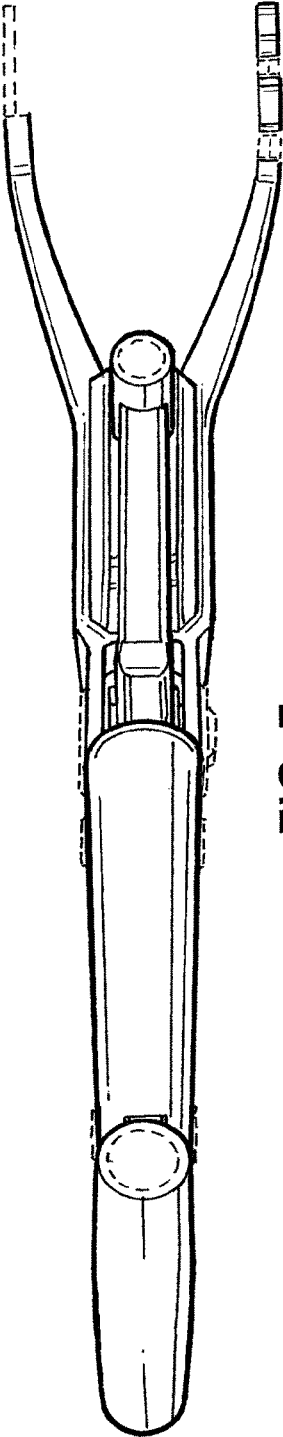

FIG. 7

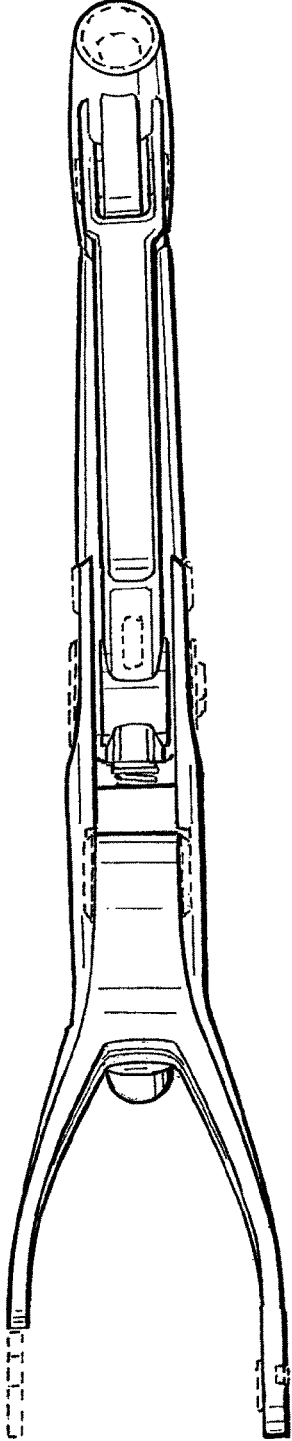

FIG. 8