



US00D840876S

(12) **United States Design Patent**
De Roeck

(10) **Patent No.:** **US D840,876 S**

(45) **Date of Patent:** **** Feb. 19, 2019**

- (54) **BICYCLE FRAME**
- (71) Applicant: **The Chillafish Company, N.V.**,
Antwerp (BE)
- (72) Inventor: **Sebastian Annemie B De Roeck**,
Westmalle (BE)
- (73) Assignee: **The Chillafish Company, N.V.**,
Antwerp (BE)
- (**) Term: **15 Years**
- (21) Appl. No.: **29/604,322**
- (22) Filed: **May 17, 2017**
- (51) **LOC (11) Cl.** **12-11**
- (52) **U.S. Cl.**
USPC **D12/111**
- (58) **Field of Classification Search**
USPC D12/111, 117; D21/412, 414, 419,
D21/423-428, 431-435
CPC B62K 3/00; B62K 3/02; B62K 3/06
See application file for complete search history.

8,967,641	B2 *	3/2015	De Roeck	B62K 9/02
					280/87.021
D729,700	S *	5/2015	De Roeck	D12/111
D735,619	S *	8/2015	Lawson	D12/111
D735,620	S *	8/2015	Pape	B62K 9/00
					D12/111
D739,308	S *	9/2015	Barnaby Latham	D12/111
D797,201	S *	9/2017	Wu	D21/432
D803,728	S *	11/2017	Kamler	D12/111
D825,395	S *	8/2018	Gafni	D12/111

* cited by examiner

Primary Examiner — Darlington Ly
(74) *Attorney, Agent, or Firm* — Kirschstein, Israel,
Schiffmiller & Pieroni, P.C.

(56) **References Cited**

U.S. PATENT DOCUMENTS

D512,664	S *	12/2005	Schreier	D12/111
D597,147	S *	7/2009	Verlinden	D21/424
D629,049	S *	12/2010	McFarland	B62K 9/00
					D12/111
D695,847	S *	12/2013	Liu	D12/111
8,844,952	B2 *	9/2014	Chen	B62K 9/00
					280/87.021

(57) **CLAIM**

The ornamental design for a bicycle frame, as shown and described.

DESCRIPTION

FIG. 1 is a top, rear, and right side perspective view of a bicycle frame showing my new design;
FIG. 2 is a front and left side perspective view thereof;
FIG. 3 is a front elevation view thereof;
FIG. 4 is a left side elevation view thereof, to which the right side elevation view is a mirror image; and,
FIG. 5 is a top plan view thereof.
The broken lines in the drawings illustrate portions of an environmental bicycle that form no part of the claimed design.

1 Claim, 5 Drawing Sheets

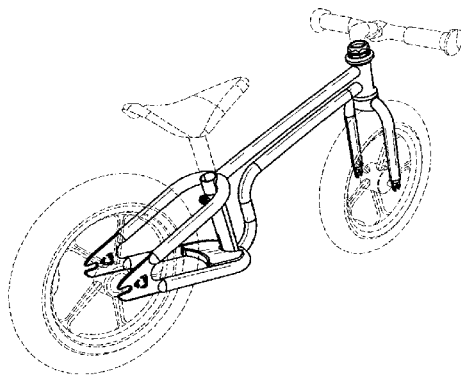

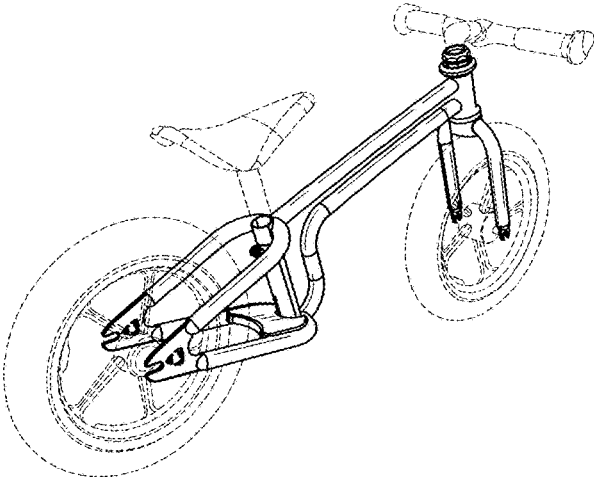

FIG. 1

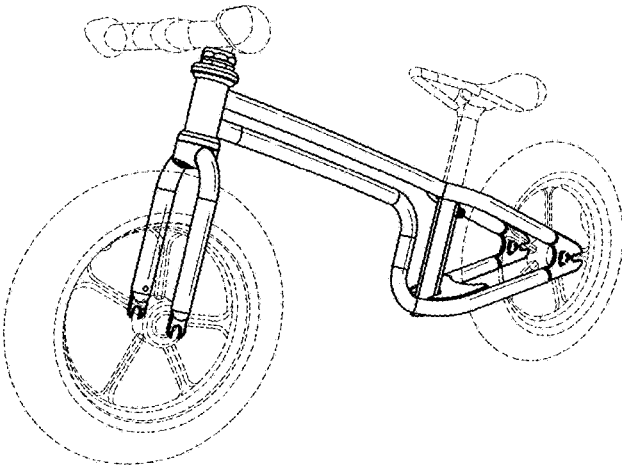

FIG. 2

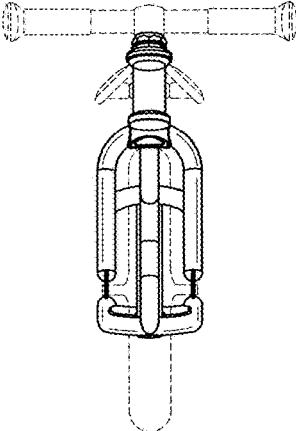

FIG. 3

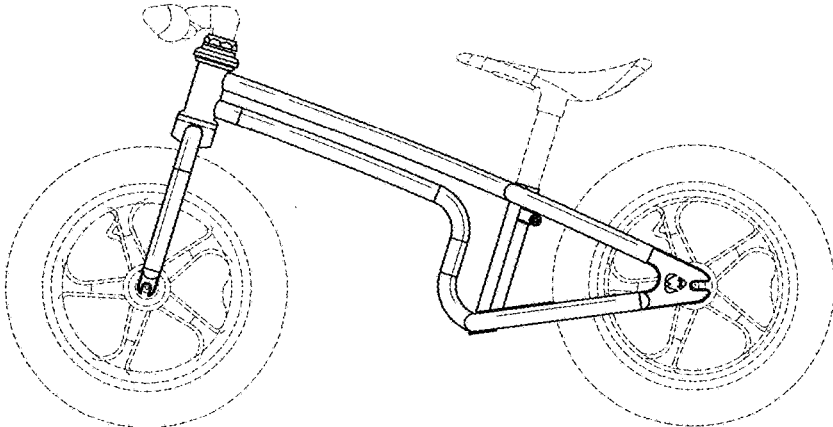

FIG. 4

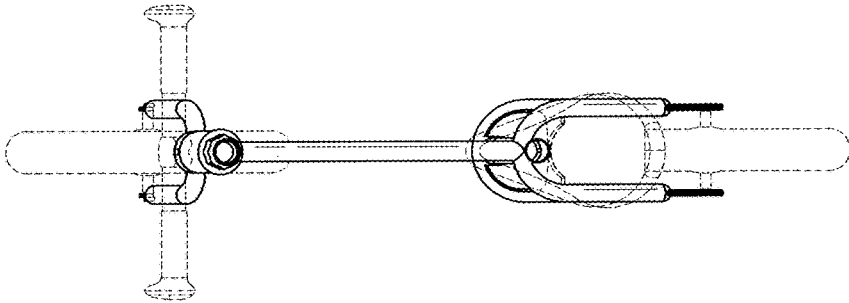

FIG. 5